

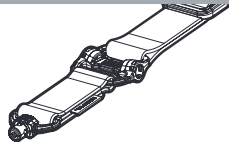

MS4[®] QDM Sling

Multi-Mission Sling System



MSD
SYSTEM

- ▲ WARNING: BEFORE STARTING, MAKE SURE THE WEAPON IS UNLOADED, THE CHAMBER IS EMPTY, AND THE SAFETY ENGAGED.
- ▲ CAUTION: PLEASE READ ALL INSTRUCTIONS BEFORE PROCEEDING. COMPONENTS UNDER SPRING PRESSURE MAY EJECT FORCEFULLY AND COULD CAUSE INJURY.
- ▲ WARNING: OBSERVE SAFE FIREARM HANDLING PRACTICES AT ALL TIMES. FAILURE TO DO SO MAY RESULT IN SERIOUS BODILY INJURY OR DEATH. MAGPUL INDUSTRIES SHALL NOT BE RESPONSIBLE FOR INJURY, DEATH OR PROPERTY DAMAGE RESULTING FROM FAULTY INSTALLATION, MISUSE, ILLEGAL USE, OR MODIFICATION OF THIS PRODUCT.

MS4 QDM SLING USAGE INSTRUCTIONS

PUTTING ON THE MS4[®] QDM

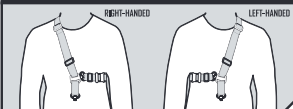

For right-handed users, place your left arm and head through the sling ensuring the QDM Swivel is oriented forward and the MSF Slider is located under the left arm. Left-handed users place the right arm and head through the sling, with MSF Slider located under the right arm.

ADJUSTING THE MS4 QDM FOR PROPER FIT

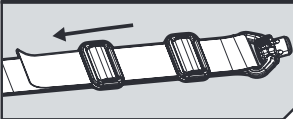

Adjust the length of the sling such that the Slider remains accessible by your non-firing hand both when tight (slung) and loose (rifle in use). After you have determined the proper length for your MS4 QDM Sling, run the tail end back through both of the Fit Buckles provided. Double back any excess material and trim only if necessary.

NOTE: If you do need to trim the webbing, re-bind the frayed end by melting it with a flame.

REAR ATTACHMENT

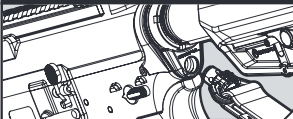

Grip both QDM Actuation Surfaces with finger/thumb and push into QD Socket on weapon.

TWO-POINT CONFIGURATION

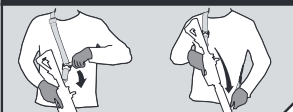

Grip both the QDM Swivel, grip Actuation Surfaces with finger/thumb and pull to detach from D-Ring. Move the QDM Swivel out to the QD Socket of choice on your Hand Guard or rail system and attach.

To return to one-point configuration, reverse these steps.

FRONT ATTACHMENT

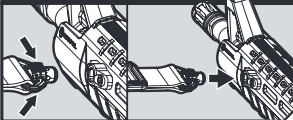

Push front QDM into Hand Guard QD Socket. Use socket on side facing forward user.

TO REMOVE QDM FROM MOUNT

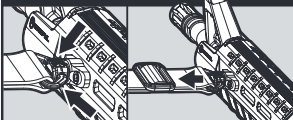

Grip both actuation surfaces with finger/thumb and pull from socket.

TWO-POINT ADJUSTMENT



To adjust the MS4 QDM Sling while in two point configuration, simply grab the Slider with your non firing hand and push down to tighten or pull up to loosen the sling.